

## Using a Filter in SPSS to Temporarily Select Cases<sup>1</sup>

A convenient way to temporarily select a subset of case for analysis in SPSS is to use a filter. (Please also see the document [http://staff.washington.edu/glynn/split\\_file.pdf](http://staff.washington.edu/glynn/split_file.pdf) for a more convenient way of running analyses for different groups). This document will use the 1991 GSS as an example. It will show how to create the syntax to create a filter, and to turn it on and off. It will also demonstrate how to use point and click to create the syntax and paste it into your syntax file.

\* Turn off any existing filters and use all cases .

```
FILTER OFF .
```

```
USE ALL.
```

\* create a variable that will have values of 1 if the .

\* criteria are met, and 0 if not .

```
COMPUTE Fsexage =(sex = 2 and age ge 25 and age le 50).
```

```
FILTER BY Fsexage .
```

```
EXECUTE .
```

\* To turn off the filter and use all cases enter the following commands .

```
FILTER OFF .
```

```
USE ALL.
```

Following is the point and click sequence that can be used to create a filter.

From the data view window, click on **Data** and then **Select Cases**.

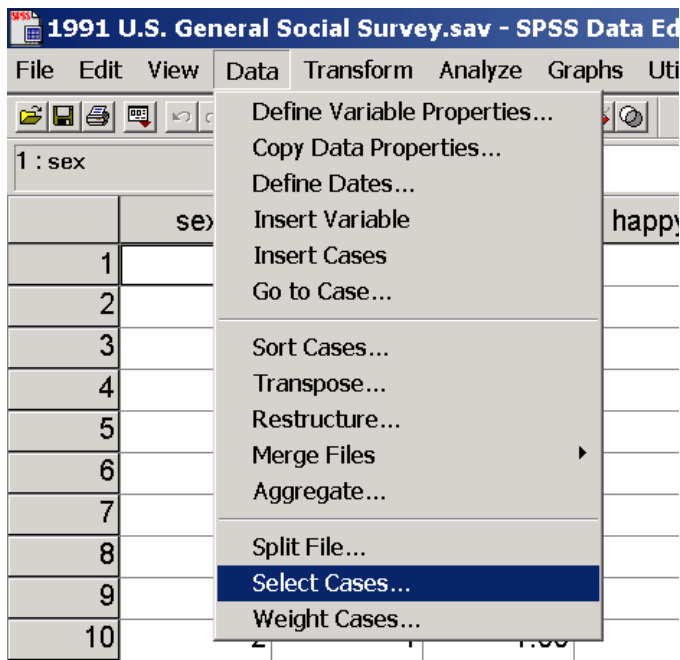

---

<sup>1</sup>Prepared by Patty Glynn, University of Washington. 4/6/03 C:\all\help\helpnew\filter.wpd

Click on “**If condition**”, make sure that **Filtered** is checked rather than deleted, and then click on **If**.

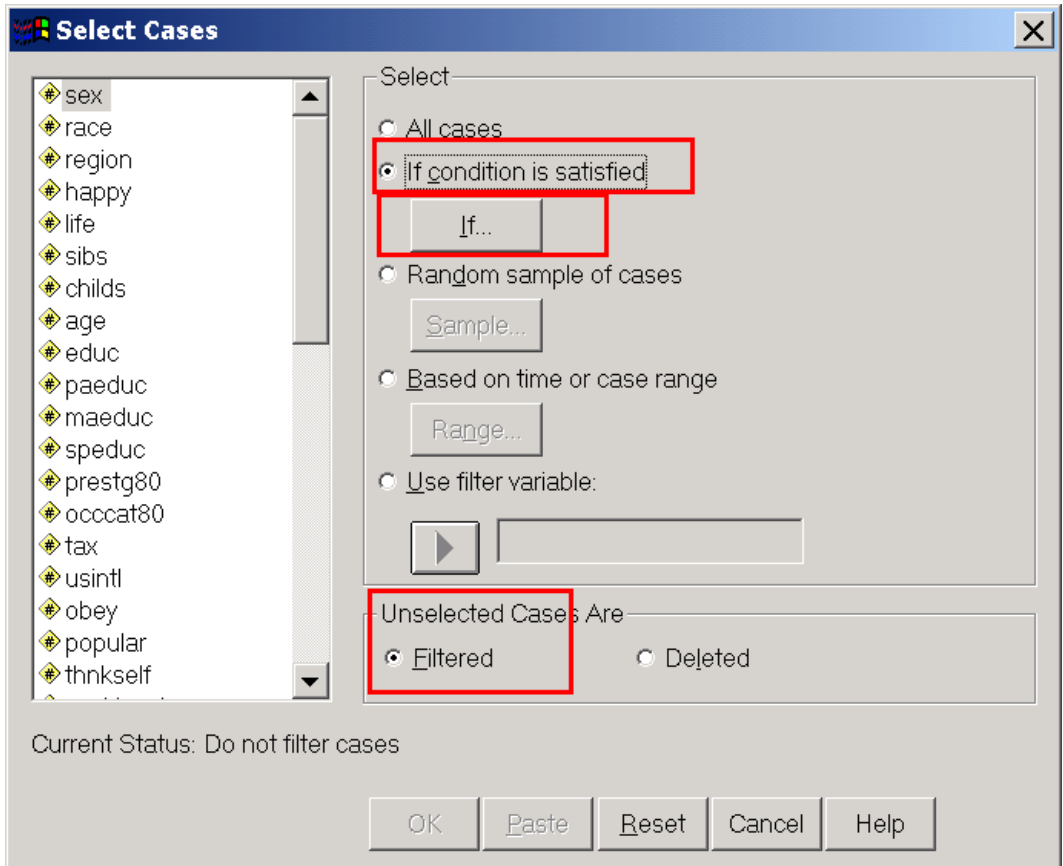

Put the conditions that you want to set into the window circled in red below, and click on **Continue**.

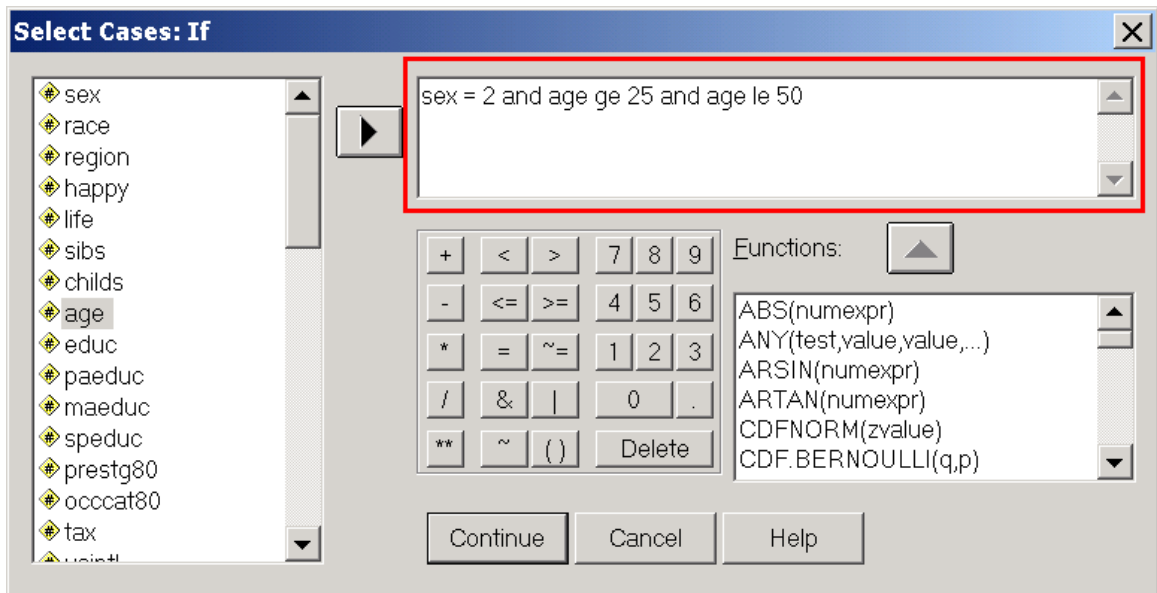

The following menu will appear again. Click on **Paste** and the syntax will be pasted into your syntax window. Run the syntax, and your filter will be applied.

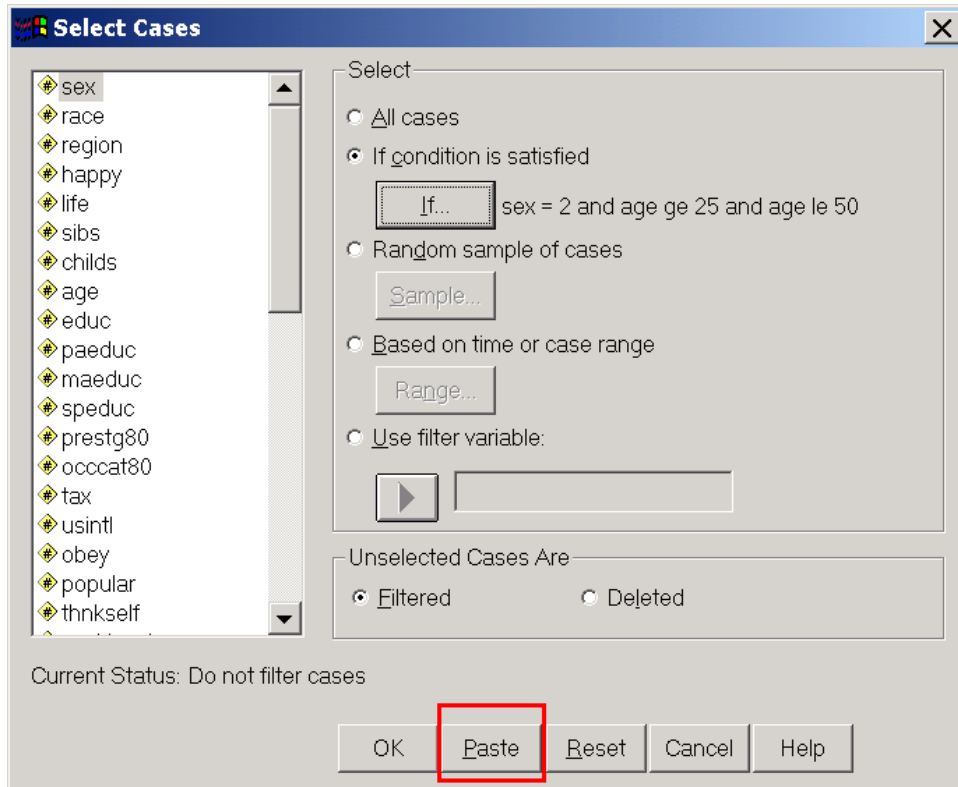

```
USE ALL.  
COMPUTE filter_$=(sex = 2 and age ge 25 and age le 50).  
VARIABLE LABEL filter_$ 'sex = 2 and age ge 25 and age le 50 (FILTER)'.  
VALUE LABELS filter_$ 0 'Not Selected' 1 'Selected'.  
FORMAT filter_$ (f1.0).  
FILTER BY filter_$.  
EXECUTE .
```